

TM

starplus-45

Amplified, Caller-ID, Call Waiting, Speaker Telephone



OWNER'S MANUAL



1st Edition

INDEX

CHAPTER	Title	Page
ONE	Introduction	3
TWO	Package checklist	4
THREE	Starplus45 features identification	5
FOUR	Installation	6
FIVE	Operating your Starplus45	8
SIX	Using Starplus45 Call Features	11
SEVEN	Taking care of your Starplus45	19
EIGHT	Specifications	20
NINE	Warranty	20

SAFETY INSTRUCTIONS

When using your Starplus45, you should always follow these basic safety precautions to reduce the risk of fire, electric shock and injury to persons.

1. Read and understand all instructions.
2. Unplug the unit from the adaptor and the telephone cord before installing a back-up battery. Do not dispose the batteries in a fire; follow your local code for properly disposing batteries.
3. Do not open the cabinet of the unit except for the battery cover. You may be exposed to a dangerous voltage and cause electric shock. Opening this product automatically voids any and all manufacturer's warranties. If you think that the unit is damaged or is in need of repair, please contact Krown Manufacturing, Inc.
4. Avoid using this unit during thunderstorms: there maybe a chance of electric shock from lightning.
5. Use only a damp cloth to clean the outside of the unit. If the unit comes in contact with any liquid source, unplug the adaptor and the telephone cord from the back panel before touching the unit. If the unit is damaged, contact Krown Manufacturing, Inc.
6. The Starplus45 is designed to work with only the power source indicated on the provided adaptor. If you are not sure about your house power source, please consult with your electric company and contact your Krown's local dealer to obtain or exchange a correct adaptor to use.
7. Pressing the "amplifier" button may subject the user to dangerous sound levels.
8. Unplug the Starplus45 from the wall outlet and contact Krown Manufacturing, Inc. if any of the following conditions occur:
 - a. When the power cord is damaged or frayed
 - b. If liquid has been spilled into the telephone
 - c. If the telephone is exposed to rain or water
 - d. If the unit did not operate normally when following the user manual, adjust only controls that are presented in the user's manual. Improper adjustment of other controls may result in damage.
 - e. If the product has been dropped or appears damaged.
 - f. If the unit exhibits a distinct change in performance.

ADDITIONAL SAFETY NOTES FOR CANADIAN USERS

NOTICE:

The Canadian Department of Communications label identifies certified equipment. This certification means that the equipment meets certain telecommunications network protective, operational, and safety requirements. The department does not guarantee the equipment will operate to the user's satisfaction. Before installing the equipment, the user should ensure that it is permissible to be connected to the facility of the local telecommunication company. The equipment must also be installed using an acceptable method of connection. The customer should be aware that compliance with the above conditions may not prevent degradation of service in some situations. Repairs to certified equipment should be made by an authorized Canadian maintenance facility designated by the supplier. Any repairs or alteration made by the user to this equipment or equipment malfunctions, may give the telecommunications company cause to request the user to disconnect the equipment.

Users should ensure for their own protection that the electrical ground connections of the power utility, telephone lines, and internal metallic water pipe system, if present, are connected together. This precaution may be particularly important in rural areas.

Caution: Users should not attempt to make such connections themselves, but should contact the appropriate electric inspection authority, or electrician, as soon as possible.

Notice: The LOAD NUMBER (LN) assigned to each terminal device denotes the percentage of the total load be connected to a telephone loop which is used by the device to prevent overloading. The termination on a loop may consist of a any combination of devices subject only to the requirement the the sum of the load numbers of all devices does not exceed 100

SAVE THESE INSTRUCTIONS

INTRODUCTION

Thank you for your purchase of the Starplus45 Amplified, Caller-ID, Call Waiting, and Speaker Telephone by Krown Manufacturing Inc. This phone is designed for the hearing, or mild to severe hearing loss users. You will be able to adjust not only the volume but you can adjust the clarity of the sound to the best quality you feel comfortable at.

The Starplus45 speaker-phone will give convenience and making hands-free telephone communication more enjoyable. You will be able to screen all calls even before picking up the phone or when you are on another call*.

Starplus45 is hearing aid compatible and will amplify the incoming sound to the maximum availability for a severe hearing loss user. It is designed with safety and flexibility for your whole family to enjoy using our telephone. You will be able to switch between automatic and manual amplification modes to protect your hearing from being exposed to dangerous sound levels.

Please read this manual very carefully before using your Starplus45 and keep it for future reference. Staple the sales receipt to this booklet. This will help you when you need to contact Krown for any warranty issues or questions about your purchase.

If you have any questions about our Starplus45 this manual did not cover, please call the Krown technical staff at 817-738-2485.

(* Caller-ID and Caller Waiting-ID are services from your local telephone company. Please contact them for details to subscribe the service to your line.)

CHAPTER 2

PACKAGE CHECK LIST

Your Starplus-45 model comes with the following parts:

- Starplus-45 amplified, Caller-ID, Call Waiting, Speaker-phone
- Handset with coiled cord
- AC adapter
- 7 foot telephone cord
- 6 inch telephone cord for use with wall mount
- Desktop/wall base adapter

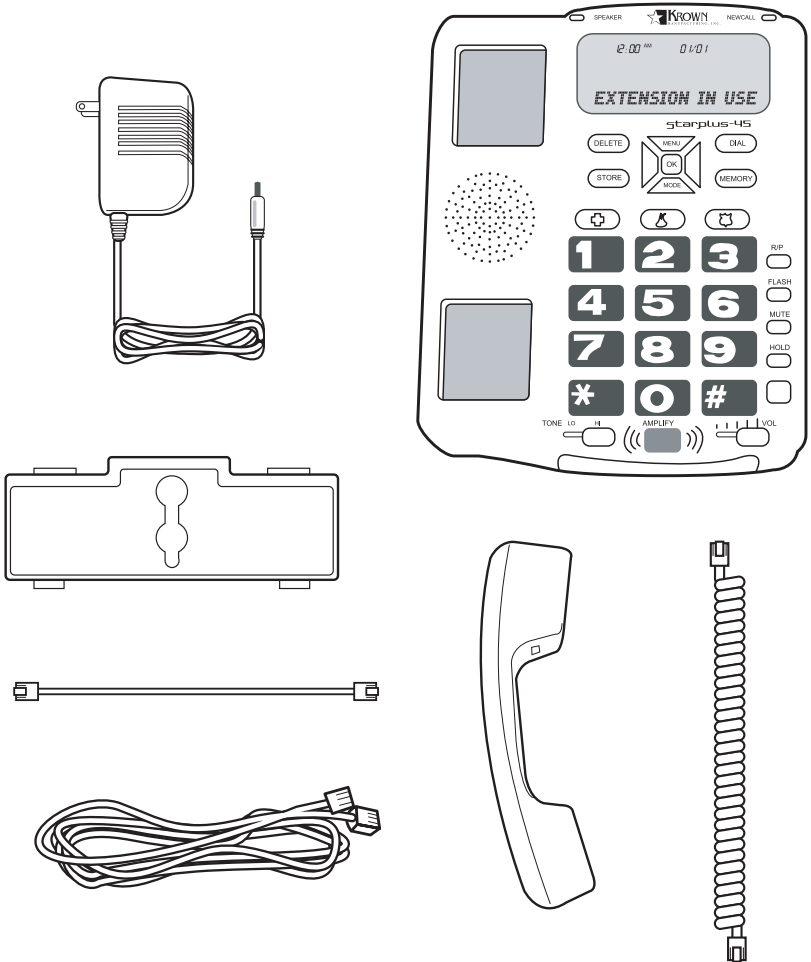

STARPLUS-45 FEATURES IDENTIFICATION

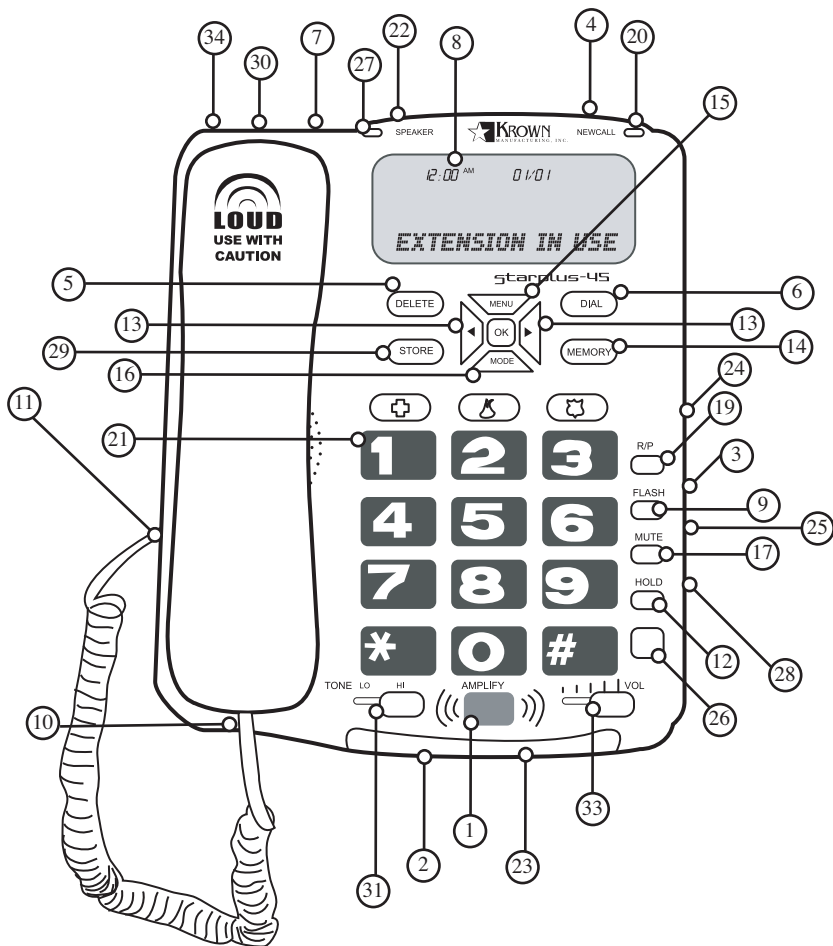

- | | | |
|----------------------|--------------------------------------|--------------------------------|
| 1 Amplify button | 13 Left & right arrow keys | 24 Ringer switch |
| 2 Amplifier LED | 14 Memory | 25 Ringer tone selector switch |
| 3 Audio jack | 15 Menu | 26 Speaker phone button |
| 4 Battery cover | 16 Mode | 27 Speaker phone light |
| 5 Delete | 17 Mute | 28 Speaker phone volume |
| 6 Dial | 18 OK button | 29 Store |
| 7 Dial mode selector | 19 Redial | 30 Telephone jack |
| 8 Display | 20 New call or message waiting light | 31 Tone slide control |
| 9 Flash | 21 Numeric keypad | 32 Voice mail waiting selector |
| 10 Handset hook | 22 Reset hole | 33 Volume slide control |
| 11 Handset jack | 23 Ring flasher | 34 12Vdc power jack |
| 12 Hold | | |

CHAPTER 4

Setup your Starplus45

Setting up your Starplus45 includes installing backup batteries and mounting the phone. Your Starplus45 will still operate normally in power outages before it falls back to a regular telephone. Replace with new batteries after each power blackout. For your safety, the Starplus45 can be used to call out with no backup batteries installed.

1. Installing backup battery

Starplus45 uses 4 AA alkaline backup batteries. Unplug the power adapter and telephone line before installing back-up batteries.

1. Insert a coin to the cover latch. Press toward the topside to release the battery cover on the bottom of the unit.
2. Remove the battery compartment cover.
3. Place four AA alkaline batteries into the compartment following the directional marks.
4. Replace the cover and press down to close the cover.

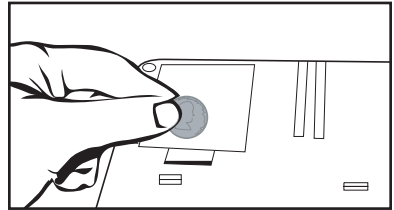

FIGURE 4.1

2. Desktop mounting

1. Install telephone cord to the wall outlet and to the telephone as shown in Figure 4.4
2. Install the handset coiled cord as shown in Figure 4.4
3. Set the dial mode selector to P (pulse) if you have pulse dialing (rotary). If you have tone dialing, do not change this switch. Manufacturer setting default is tone dial mode.
4. Plug the AC adapter cord into the power jack located on the topside of the telephone. Plug the AC Adapter into a standard 120VAC wall outlet.
5. Pick up the handset or press speaker button and listen for a dial tone. Your Starplus-45 is ready to use.

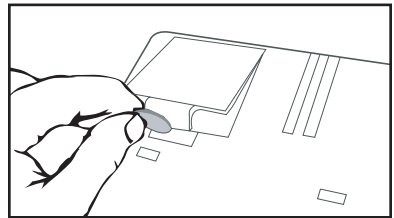

FIGURE 4.2

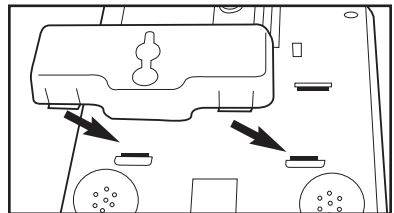

FIGURE 4.3

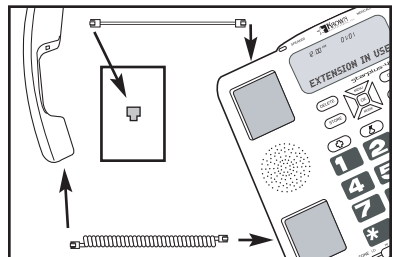

FIGURE 4.4

3. Wall mounting

- a. Install wall mounting plate as shown in Figure 4.3
- b. Take the handset hook out and flip it to reverse position as shown in Figure 4.7. It will hold the handset when the phone is in a vertical position.
- c. Use the provided 6 inch modular cord to mount the phone as shown Figure 4.8.
- d. Repeat step 3 through 6 of Desktop mounting section to complete the setup.

The Starplus-45 will automatically update the current date and time from the first Caller ID received after the setup is finished. Contact your local telephone company to activate Caller ID service the day before. If you wish to set the TIME / DATE manually, after setup, the telephone will beep and the display will show “SET TIME / DATE.” The display will show, after 10 seconds, the number of calls received “MISSED -00-, ANSWER -00-” as shown in Figure 4.5.

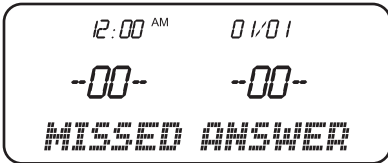

FIGURE 4.5

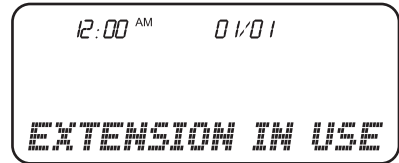



FIGURE 4.6

NOTE: When the telephone is not in use, if the line is being used by another phone, the display shows “EXTENSION IN USE”..  on the screen and BATTERY LOW LED comes on. This means back up batteries are either low or not fitted properly. See Figure 4.6.

4. Setting up an external signaler

Connect the external ringer device direct to the second phone jack located on the top left side of the unit as shown in Figure 4.9.

5. Connecting to an assistive listening device

Your Starplus-45 provides an audio jack to connect direct to an assistive audio listening device. It is not designed for a hands-free headset or a phone headset.

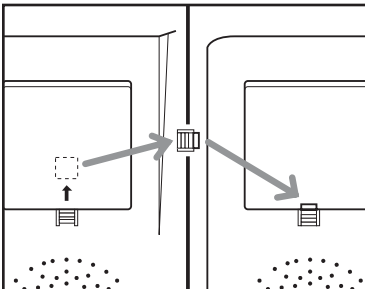

FIGURE 4.7

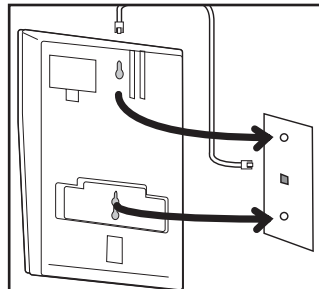

FIGURE 4.8

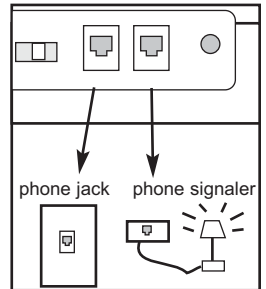

FIGURE 4.9

CHAPTER 5

Operating your Starplus-45

1 MAKING AND RECEIVING CALLS

	Using the handset	Using the speakerphone
MAKING A CALL	<ol style="list-style-type: none">1. Pick up the handset. Listen for the dial tone2. Dial desired number. Your conversation starts when the other end answers your call.3. Hang up upon completion of the call.	<ol style="list-style-type: none">1. Key in desired telephone number.2. Press DIAL (The phone will automatically go to speakerphone mode).3. To hang up, press SPEAKER key.
RECEIVING A CALL	<ol style="list-style-type: none">1. Pick up the handset and start your greeting2. Hang up upon completion of the call.	<ol style="list-style-type: none">1. Press SPEAKER key and start your greeting.2. To hang up, press SPEAKER key again.

This is the Figure for the display when using the handset.

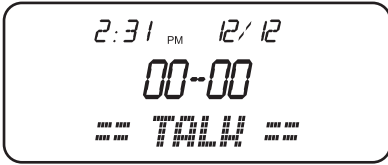

FIGURE 5.1

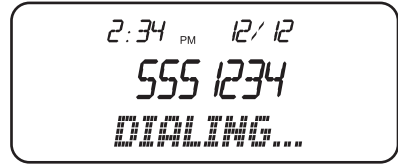

FIGURE 5.2

SPEAKPHONE

You can place a call on speakerphone anytime by pressing **SPEAKER** during a call, then place the handset on hook. Picking up the handset (off hook) will transfer the call from speaker-phone to the handset. The display will show **SPEAKERPHONE**, and the **SPEAKER** LED will light in this mode.

This is the figure for the display when using the speaker phone

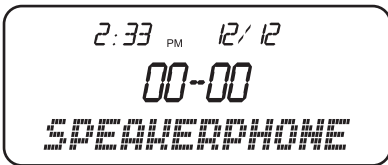

FIGURE 5.3

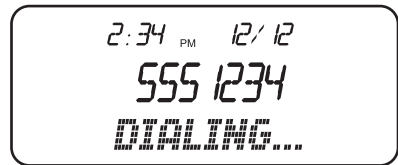

FIGURE 5.4

Your Starplus45 comes with a LED backlight keypad and display. It will turn on automatically when you are making a call. The “New Call” LED will flash to indicate a new call was received. This LED feature is also used as a message waiting * indicator.

(*Message Waiting is a service offered by your local phone company or feature of your internal phone system)

2. Adjusting sound levels

A. INCOMING VOICE VOLUME

By sliding the **VOLUME** control, you can adjust the sound level of incoming calls up to 20 dB. by pressing “**AMPLIFY**” button, you can control amplification up to 45dB.

1. Pick up the handset and press the **AMPLIFY** button once, the “)))” icon appears on the top left of the display and the **AMPLIFY LED** will come on.
2. Slide the volume control when the other person is talking to adjust to a comfortable level.

The amplifier feature turns off automatically when you hang up the phone. To reactivate the amplifier, repeat the above steps. This feature is used for a household with a hearing and hearing loss. To set up for this feature to always stay on, slide the “**AMP**” switch to **AUTO**. (Located on the bottom of the telephone)

B. INCOMING VOICE TONE

Adjusting the tone control button will give extra amplification on the frequencies of your hearing loss. It makes the incoming sound stream more understandable and appear to be clearer. You may adjust the tone control as many times as possible depending on different speakers.

1. Pick up handset and press **AMPLIFY** button.
2. Adjust the **TONE** control while the other person is talking. More high-pitched sounds will go through if moving toward **HIGH**.

C. BASE SPEAKER VOLUME

Press **SPK VOLUME** toward “+” sign or “-” sign for more or less amplification. It will go up to 20dB maximum. No amplify button needed.

D. RINGER VOLUME

Starplus45 will delivery a maximum ring volume up to 95dB if set at **HI** level. Adjust to half level or turn off the ringer by adjusting the **OFF/LO/HI** position.

E. RINGER TONE

While the phone is ringing, you can adjust the ringer tone to the **LO** or **HI** position to experience with high or low pitch ring tone.

F. CALL TIMER

When the handset is picked up or the **SPEAKER** button is pressed, the call counter will begin and show the elapsed time **XX-XX** on the display screen.

CH. 5 (CONT)

G. LCD BACKLIGHT DISPLAY

The LCD has a back light that will turn on under the following conditions:

- Any incoming call
- Picking up the handset
- Pressing any button

NOTE: The backlight will turn off automatically 15 seconds after the last activity. The AC adapter must be plugged into the unit to enable the BACK LIGHT.

H. ADJUSTING LCD CONTRAST

1. Press MENU to toggle the display to -3- "LCD CONTRAST"
2. Press ◀ to increase or ▶ to decrease contrast level from 0 to 9.
3. Press OK or MENU to exit. Press DELETE to abandon. The default LCD CONTRAST level is 3.

I. SETTING DATE AND TIME

Starplus45 will adjust date and time by the first received caller ID. To set up date and time manually:

1. Press MENU to toggle the display to "SET TIME/DATE"
2. Key in new date and time. Press OK to move between numbers. Press ◀ or ▶ to select AM, PM.
3. Press MENU to exit, or press DELETE to abandon.

CHAPTER 6

Using your Starplus45 Call features

1. MUTE

Press **MUTE** to turn off the handset microphone, allowing private conversations in the same room without the other party hearing.

Press **MUTE** again to resume the conversation with the calling party.

NOTE: During the mute condition, the display will show < MIC MUTE >.

2. HOLD

1. To place a call on hold, press **HOLD** and placed the handset on hook. The **HOLD LED** will light, the display will show < **CALL ON HOLD** > .
2. To begin conversation again, pick up the handset or press **SPEAKER**. By picking up another phone, the hold feature will automatically reconnect.

MUSIC ON HOLD

When a call is placed on hold, a tuned melody will be generated to reassure your caller that the call has not been disconnected.

3. FLASH

Features such as call waiting and, 3-way calling* and other can be placed by using this feature. These features are optional services from your local telephone company.

4. REDIAL

To redial the last number dialed:

Press **R/P** and the display will show the latest dialed number. Press **DIAL**. The Starplus45 will enter **speaker-phone mode** and dial the displayed number.

Pick up the handset and press **R/P button**, the telephone will redial the last number dialed.

NOTES: The redial memory stores the first 32 digits of any number dialed. The number dialed will be truncated if exceeds 32 digits.

5. MEMORY DIAL AND SPEED DIAL:

Starplus45 has three buttons reserved for speed dial emergency numbers. These three numbers and another 100 phone numbers can be programmed into the **MEMORY** of your Starplus45. Each memory location can store a maximum of 32 digits and 15 letters. You must complete each step within 15 seconds. The default memory will be empty.

* 3-way calling is a service from your local telephone company. Please contact them for details to subscribe the service to your line.

CH. 6 (CONT)

A. EDITING AN ENTRY

To program KROWN telephone number, 8177382485 into memory:

1. Press **STORE** (Display shows **STORE TO ?**)
2. Press **MEMORY** (Display shows **NUMBER ?**)
3. Enter the phone number 8 1 7 7 3 8 2 4 8 5 using the phone keypad
4. Press **STORE** or **OK** (Display shows **NAME ?**)
 *Enter the name K R O W N using the numeric keypad (5577666966)
5. Press **STORE** or **OK**, the phone will beep and the display will show **STORED**
 If you do not want to store a name, skip step 4.

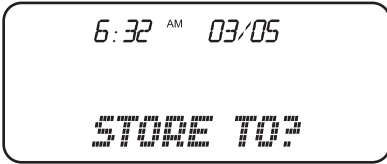

FIGURE 6.1

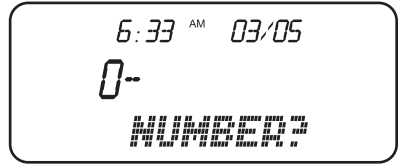

FIGURE 6.2

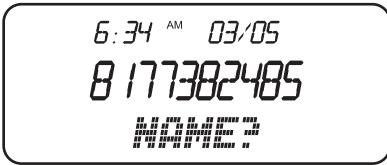

FIGURE 6.3



FIGURE 6.4

- NOTE:**
- To add a space before another word, press number 1 once.
 - If you make a mistake while entering the number, or name. Press ◀ to move the cursor right, press ▶ to move the cursor left and press DELETE to delete the letter.
 - Letters are always inserted to the left of the cursor
 - Always store the area code together with telephone numbers.

Table 1: using the numeric keypad to enter a name.

KEY	1st	2nd	3rd	4th	5th	6th	7th	8th	9th
1		-	'	()	&	,	.	1
2	A	B	C	2	A	B	C	2	A
3	D	E	F	3	D	E	F	3	D
4	G	H	I	4	G	H	I	4	G
5	J	K	L	5	J	K	L	5	J
6	M	N	O	6	M	N	O	6	M
7	P	Q	R	S	7	P	Q	R	S
8	T	U	V	8	T	U	V	8	T
9	W	X	Y	Z	9	W	X	Y	Z
*	*	*	*	*	*	*	*	*	*
0	0	0	0	0	0	0	0	0	0
#	#	#	#	#	#	#	#	#	#

B. EDITING AN EMERGENCY BUTTON

These emergency buttons are empty and you must choose the number for each button. Select the number reserved for:



Follow step 1 of the above “EDITING AN ENTRY”. Press the corresponding button for hospital, fire, police. Continue with step 3 to 5 to completely enter an emergency number.

Press the corresponding button again to display name and number you entered.

Press **mode** to exit display name and number and return to main display.

C. ADDING A PAUSE TO DIAL SEQUENCE

You may wish to press R/P to insert a pause between numbers. It is used for dialing out from a telephone switch board, or making a short cut or “Cheat-sheet” when banking by phone or Tele-teller system.

Pressing R/P will show a “P” on the LCD to indicate a 2 second pause in the dialing sequence. Each pause counts as one digit.

D. USING TONE SERVICES ON A PULSE (rotary) LINE

If you have pulse dial phone line and area calling a tone dial Tele-teller service, you can send out required signals without changing the dial mode.

1. Dial the servite's main number in pulse dial mode.
2. When the service answers, press * , upper **O** will be displayed; or press # , lower **O** will be displayed. From that point any additional numbers you dial will be sent as tone signals.
3. After you hang up, your Starplus45 will reset the dial mode to pulse dial automatically.

E. SPEED DIALING***REVIEW NUMBERS FROM THE MEMORY**

Press **MEMORY** button.

The display shows **ITEM -XX-**.

XX is the total memories stored in the memory. Enter the first letter of the name (e.g “K” for KROWN): Press number 5 twice and scroll with **▶** until the name and number you want to review shows on the display.

NOTE: If the number is longer than 15 digits, the number will shifted to the left and pause for 1 second automatically until the end of the number has been reached. The Starplus45 will exit display mode automatically 15 seconds after last activity.

CH. 6 (CONT)

*DIALING NUMBERS FROM THE MEMORY

By using the handset: Pick up the handset and follow the sequence “REVIEW A NUMBER FROM THE MEMORY” until the display shows the name and number that you want to dial. Press **DIAL**.

By using the speakerphone: Choose the desired name in MEMORY. Press **DIAL**. The phone will enter speakerphone mode and will dial the displayed number.

*EMERGENCY DIALING

Press the corresponding button for hospital, fire, or police and press **DIAL**.

F. CHANGING A SPEED DIAL NUMBER

If you want to change the number stored in an emergency button or memory:

1. Press emergency button or **MEMORY** to display the number (If you press **MEMORY**, use ◀ or ▶ to search for the number.)
2. Press **OK** on the number you want to change, the display shows “**NUMBER ?**”. The cursor will now be on the right of the last digit.
3. Move the cursor to the number you would like to edit by using ◀ or ▶
4. Press **DELETE** to erase the number. Key-in the new number by using the numeric keypad
5. Press **STORE** or **OK**. The display will ask if you want to change name by showing “**NAME ?**” for 10 seconds. The old name will be displayed with cursor on the right of the last letter.
6. Move the cursor to the letter to be edited by using ◀ or ▶ .
7. Press **DELETE** to erase the letter, then key-in the desired letter using the numeric keypad.
8. Press **STORE** or **OK**, the new number and name will be stored into memory followed by a beep. The display now shows “**STORED**”.

G. DELETING A SPEED DIAL NUMBER

1. Press speed dial button or **MEMORY** to display the number you want to erase.
2. Press **DELETE** (Display shows “**DELETE ?**”)
3. Press the **DELETE** or **OK** to confirm
4. Starplus45 will beep and the display shows **DELETED**.

H DELETING ALL MEMORY ENTRIES

1. Press **MEMORY** (Display shows “**ITEM -XX-**”).
2. Press **DELETE** (Display shows “**CLEAR MEMORY ?**”).
3. Press **DELETE** or **OK** to confirm. Starplus45 beeps and the display shows **DELETED**.

6. USING CALLER ID

Caller Identification is a service offer by your local telephone company. If you are not sure if you have this option in your telephone service contract, contact them for more detail. Starplus-45 will automatically update date and time after receiving the first Caller-ID call. Starplus-45 can record up to 50 missed calls, 50 answered calls, and 10 dialed number history. The oldest entry will be erased if the entry is over 50 calls or 10 dials. Starplus-45 also can display the identification of a call when you are on another call or caller ID in Call Waiting. The identification will be displayed with **CW** icon to let you know there is another call waiting on line. Contact your telephone company to have this service installed.

A. SETTING LONG DISTANCE CODE

Long Distance Code has a default setting of 1. If you use Starplus-45 with a PBX system you may want to change the process of dialing to start by a 9.

1. Press **MENU** until **-1- SET LDS CODE** appears. Default value for long distance is -1-.
2. Press **◀** or **▶** to shift long distance code to **1** or **9**.
3. Press **OK** or **MENU**.

NOTE: If you do not complete the setting within 15 seconds, Starplus45 will abandon the current change and exit the setup screen to the main display.

B. SETTING AREA CODE

Starplus45 can place a call back from the Caller ID list. You need to setup area code for Starplus45 to dial if you choose to dial from the Caller ID list. Default for area code is -000-.

1. Press **MENU** button until **-000- "SET AREA CODE"** appears.
2. Key a new area code.
3. Press **MENU** to complete.

C. DISPLAYING CALLER ID INFORMATION

To review call history, Press **MODE** to toggle from MISSED CALL, ANSWERED CALL, DIALED NUMBER, and return to main menu. During review, you can use "STORE, DELETE, DIAL" keys to store, delete, or dial a phone number from the list.

VIEW MISSED CALL

1. Press **MODE** to toggle the display to **MISSED CALL -XX-**.
2. Use the ◀ or ▶ to list the missed calls. The new missed call will be displayed first. After all missed calls are displayed, the new-call LED stops flashing.

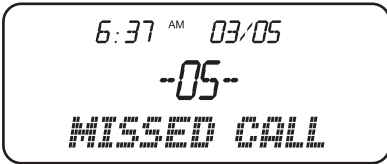

FIGURE 6.1

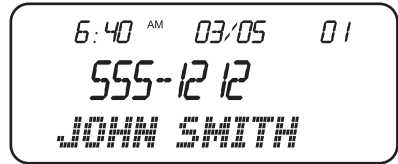

FIGURE 6.2

VIEW ANSWERED CALL

1. Press **MODE** to toggle the display to **ANSWERED CALL -XX-**.
2. Use the ◀ or ▶ to list the answered calls.

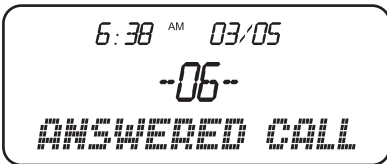

FIGURE 6.3

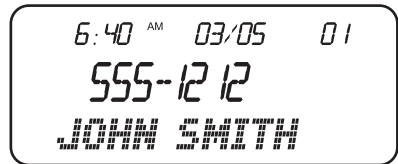

FIGURE 6.4

VIEW DIALED NUMBER

Starplus45 can keep last 10 dialed numbers the dialed history.

1. Press **MODE** to toggle the display to **DIALED NUMBER -XX-**.
2. Use the ◀ or ▶ to view the answered calls.

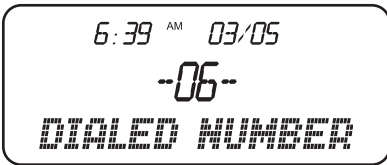

FIGURE 6.3

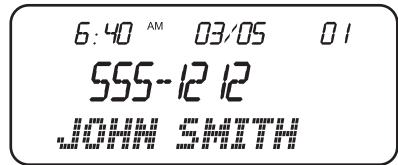

FIGURE 6.4

D. DELETING A CALL FROM THE CALL HISTORY

1. Press “**MODE**” to toggle the display from missed calls, answered calls and dialed calls.
2. Use the ◀ or ▶ to shift the list to the number you wish to delete.
3. Press **DELETE** once. The display will show “**DELETE ?**”.
4. Press **DELETE** or **OK** to confirm Starplus45 will beep once. The display will show “**DELETED**”.

E. DELETING ALL CALLS

1. Press **MODE** to toggle the display to **MISSED CALL**, **ANSWERED CALL** or **DIALED NUMBER** to delete that list.
2. Press the **DELETE** once and the display will show “**DELETE ALL?**”
3. Press the **DELETE** or **OK** to confirm.

NOTE: You can't erase missed calls before it has been reviewed.

F. TRANSFERRING A CALLER ID NUMBER TO SPEED DIAL MEMORY

When a caller ID number is displayed you can transfer it to a speed dial memory by pressing “**STORE**” button. Select a speed dial button or press memory to save it to speed dial memory. Press **STORE** twice to save.

G. DIALING FROM THE CALLER ID LIST

The caller ID displays only seven digits of the caller's phone number if the area code is the same with your area code stored in memory. To dial from the caller ID list, first display the number you want to dial from previous section “displaying caller ID information”. Press **OK** button to toggle between the method of dialing.

-Dial 7 digit phone number (ex: 738-2485)

-Dial long distance code with phone number (ex: 1-738-2485)

-Dial local area code with phone number (ex: 817-738-2485)

-Dial long distance code, area code, and the phone number (ex: 1- 817-738-2485)

Press **DIAL** to dial that number. You must setup area code and long distance code in order for these functions to work correctly.

7. MESSAGE WAITING

If you subscribe to message waiting service from your telephone company, your phone will inform you when you have a message. The “**MSG WAITING ON**” appears only 8 seconds on the display, but  icon and the message LED will flash until you retrieve the message from the call center. You can turn this feature off if you choose not to have voice-mail-box service from your phone company. If you use Starplus-45 in a PBX system with message waiting features, turn the switch to **ON**. The message waiting feature does not work with stutter dial tone service.

8. VIP INCOMING ALERT

When an incoming call is matched with the exact number stored in **MEMORY**, the symbol **VIP** will be displayed. If **VIP ALERT** is **ON**, Starplus45 will send out a beep tone to alert you to a **VIP** incoming call.

To set **VIP ALERT ON**

1. Press **MENU** to toggle the display “**VIP ALERT ON**”.
2. Press **◀** or **▶** to choose **VIP ALERT ON** or **OFF**.
3. Press **OK** or **MENU** to exit, or press **DELETE** or **MODE** to abandon.

NOTE: If **VIP ALERT** is **ON**, the symbol **(••)** will be displayed when there is a **VIP** call. The default **VIP** alert is **ON**.

CH. 6 (CONT)

9. NAME TAGGING

When an incoming call is matched with a number stored in MEMORY, the name stored in the MEMORY will be tagged to the incoming phone number.

CALL WAIT ID ON/OFF

1. Repeatedly press **MENU** until “*CALL WAIT ID ON*” appears.
2. Press ◀ or ▶ to choose CALL WAIT ID ON/OFF.
3. Press **OK** or **MENU** to complete the setting, or press **DELETE** to disregard the setting and return to standby mode, or you can do nothing and wait for 15 seconds to disregard the setting and return to standby mode..

NOTE: The default CALL WAIT ID setting is ON.

10. RESETTING THE PHONE

If your Starplus45 stops working properly, use a paper clip end to insert to **RESET** hole to reload the original manufacturer’s settings.

CHAPTER 7

TAKING CARE OF YOUR STARPLUS-45

Starplus-45 is designed for indoor use only. Do not set the unit in direct sun light. It will damage the LCD which is not covered under the manufacturer warranty.

CLEANING:

Unplug the Starplus-45 and use only a damp cloth to clean up the outside of the housing. Never use liquid or aerosol cleaner to spray direct to the display or body of the phone. Keep the starplus45 from dust or moisture sources.

BATTERIES:

Replace the backup batteries once a year or after a power outage to keep starplus-45 in good performance.

TROUBLESHOOTING:

Q: The display of my StarPlus-45 is not working.

A: Check the adapter and make sure it is plugged into the electric outlet and the cord is plugged into the power jack of the phone.

Q: My Starplus-45 does not ring.

A: Check the ringer selector to make sure it is not in the OFF position. Adjust the ring volume to HI or LOW for your comfort.

Q: My speed dial memory is erased.

A: The memory of the Starplus-45 is saved by the power of the phone line. There is a power interruption at the telephone center or your Starplus-45 has been disconnected from the phone line longer than 30 minutes. It will erase the memory of the Starplus-45.

REPAIR:

Please pack your Starplus-45 in the original shipping carton with a note describing the problem you have and send it to:

Krown Manufacturing Inc.
ATTN: Technical Department
3408 Indale Road
Fort Worth TX 76116

CHAPTER 8

SPECIFICATIONS

Physical dimensions:	7" X 9.1" X 2 1/8"
AC Adapter	12VDC 1000mA
Batteries:	4 AA Alkaline (not included)
Keypad:	1 1/16" large, back-lighted, high contrast keys
Ringer volume:	95 dB
Handset:	hearing aid compatible
Memory:	50 answered calls 50 missed calls 10 dialed numbers 3 emergency speed dial buttons
Connections	RJ11 modular jacks to connect to a standard analog phone line or compatible line. 3.5mm audio listening assistive device.
Approval	FCC approved

CHAPTER 9

Warranty

Krown Manufacturing Inc. Warrants that the StarPlus-45 sold by Krown Manufacturing is free from defects in materials and workmanship under normal use and service for one year. This warranty is applicable only to the original purchaser of the MTCP-106 when accompanied by a sales receipt stating the date of purchase and the name of company from which purchased. This warranty is in lieu and excludes all other warranties, expressed or implied, including any implied warranty of merchantability or fitness and of any obligation on the part of Krown Manufacturing. If the StarPlus-45 shall prove to be defective, then Krown Manufacturing shall either replace or repair the StarPlus-45 at no cost to the original purchaser within one year of the date of purchase. During the one year period you may return the StarPlus-45 to Krown Manufacturing at the following address:

Krown Manufacturing, Inc.
3408 Indale Road
Fort Worth, Texas 76116

Shipping charges are at the customer's expense. Please include a check or money order made out to Krown Manufacturing in the amount of \$10.00 to cover shipping and handling. This warranty does not extend to any StarPlus-45 sold by Krown Manufacturing which has been subjected to misuse, neglect, accident, improper application, improper installation, or any use in violation of the instruction furnished by Krown Manufacturing. This warranty does not extend to or apply to any StarPlus which has been repaired or altered by any persons who have not been expressly approved by Krown Manufacturing. Batteries provided with this product are not covered under this warranty.

Krown Manufacturing shall not be liable for any special or consequential damages or for loss or expense directly or indirectly arising from use of the products or any inability to use them either separately or in combination with other equipment or product accessories or from any other cause. This warranty is only applicable to a product purchased through Krown Manufacturing, CompuTTY, or a Krown dealer. Other than as stated herein, there are no other warranties whether by the sample or model, by description or quantity, whether expressed or implied, and there are no implied warranties of fitness for a particular purpose or of merchantability.



3408 Indale Road, Fort Worth, TX 76116

Voice/TTY: (817) 738-2485 or (817) 738-8993

Fax: (817) 738-1970, E-mail: info@krowntty.com

ORDERS: 1-(800)-366-9950